



Self-adjusting NTP clocks

for offices, industry, hospitals,
and public areas

■ PEWETA is one of the leading manufacturers and suppliers of analogue as well as digital wall clocks. Our scope of products includes a multitude of articles for a wide range of applications.

NTP (Network Time Protocol) is the standard protocol for synchronizing time in IT networks. PEWETA NTP clocks (SNTP clients) may receive the NTP protocol and adjust themselves autonomously. Power is supplied by PoE (Power over Ethernet). NTP clocks can be used wherever a LAN network with NTP/PoE is available.

Type series 270 Indoor clock

dia 250–400 mm single face, wall mounting



91.270.311



91.270.421

Face print	Face diameter ▶	250 mm Item No.	300 mm Item No.	400 mm Item No.
Arabic numerals		91.270.211	91.270.311	91.270.411
DIN bar markings		91.270.221	91.270.321	91.270.421

Universal wall clock, can also be mounted to a media pillar

Available with case diameters 265 mm, 315 mm, and 415 mm. Plexiglas® XT plastic case, face printed with Arabic numerals or DIN bar markings. Black hour and minute hands, red second hands.

Extra
Front ring for fitting clocks of this type series with a case diameter of 265 mm to media pillars made from metal (Item No. 01.270.200) or wood (Item No. 01.270.220)

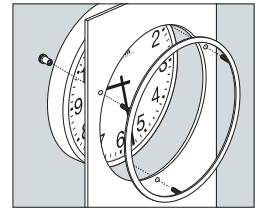

Installation in a media pillar using a front ring (extra)

Type series 271 Indoor clock

dia 250–400 mm single face, wall mounting



91.271.311



91.271.321

Face print	Face diameter ▶	250 mm Item No.	300 mm Item No.	400 mm Item No.
Arabic numerals		91.271.211	91.271.311	91.271.411
DIN bar markings		91.271.221	91.271.321	91.271.421

Option		Suffix	Suffix
Snap-tight fixture	not available	-57	-57

Sturdy, prestigious wall clock

Available with case diameters 265 mm, 300 mm, and 400 mm. Sturdy metal case, enamelled RAL 9016, face printed with Arabic numerals or DIN bar markings. Black hour and minute hands, red second hands.

Option:
■ **Snap-tight fixture**, prevents the clock from dropping or being wrenched off. No protection against thrown balls. Available for case diameters 300 mm and 400 mm.

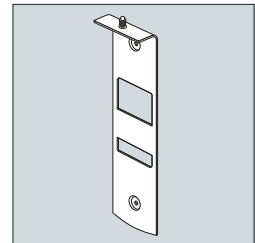

The Snap-tight fixture prevents the clock from dropping or being wrenched off.

Type series 272 Indoor clock

dia 250–400 mm double face for wall/ceiling mounting



91.272.312



91.272.423

Face print	Face diameter ▶	250 mm Item No.	300 mm Item No.	400 mm Item No.
Arabic numerals	Mounting ▼	91.272.212	91.272.312	91.272.412
		91.272.213	91.272.313	91.272.413
DIN bar markings	wall	91.272.222	91.272.322	91.272.422
	ceiling	91.272.223	91.272.323	91.272.423

Sturdy clock for long hallways

Available with case diameters 270 mm, 320 mm, and 420 mm. Sturdy metal case, enamelled in RAL 9016 (traffic white), choice of wall or ceiling mounting (standard length 150 mm). Face printed with Arabic numerals or DIN bar markings. Black hour and minute hands, red second hands.

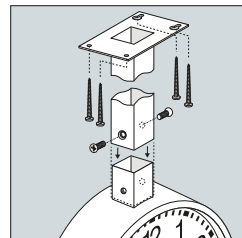

Ceiling mounting in any length desired (surcharge)



Clock case with lugs (option) for suspension

Type series 350 **Clock for large spaces** for indoors
single face, wall mounting



Extraordinarily sturdy wall clock for industrial environments and/or large reading distances

Available with case diameters 446 mm, 546 mm, and 646 mm. Very sturdy metal case, enamelled RAL 9006, choice of face print with Arabic numerals or DIN bar markings. Hour and minute hands painted black.

Options:

- **Packaging against dust and spray (IP54)**, protection against water and dust.
- **Resistance to thrown balls acc. to DIN 18032/3**
Clocks of this type series are also available resistant to thrown balls and thus suitable for gymnasiums and other sporting facilities. Very sturdy case with three-point mounting as a safeguard, proof against wrenching off the hook. Front glass is a 2-layer laminated safety glass, 6 mm thick. The clocks are certified and labelled "resistant to thrown balls according to DIN 18 032, part 3".

Face print	Face diameter ▶	400 mm Item No.	500 mm Item No.	600 mm Item No.
Arabic numerals		91.350.411	91.350.511	91.350.611
DIN bar markings		91.350.421	91.350.521	91.350.621
Options				Suffix
Packaging against dust and spray (protection grade IP 54)				-54
Resistance to thrown balls acc. to DIN 18032, part 3				-59

Type series 352 **Clock for large spaces** for indoors
double face for wall/ceiling mounting



Extraordinarily sturdy double face clock for wall or ceiling mounting

Available with case diameters 446 mm, 546 mm, and 646 mm. Very sturdy metal case, enamelled RAL 9006. Choice of double bracket wall or ceiling mounting, standard bracket length cir. 210 mm, or sturdy metal tube suspension from the ceiling, tube length cir. 1000 mm. On request, custom length available optionally. As an option, available with lugs for suspension by ropes or chains. Face printed with Arabic numerals or DIN bar markings. Hour and minute hands painted black.

Options:

- **Packaging against dust and spray (IP54)**, protection against water and dust.
- **Cases with mounting lugs for suspension by ropes or chains**
The cases of these clocks are also available with mounting lugs for suspension by ropes or chains in very high halls. This allows the mounting height of the clock to be adjusted as required. Ropes or chains are not included in delivery shipment.

Face print	Face diameter ▶ Mounting ▼	400 mm Item No.	500 mm Item No.	600 mm Item No.
Arabic numerals	wall	91.352.412	91.352.512	91.352.612
	ceiling	91.352.413	91.352.513	91.352.613
	tube	91.352.414	91.352.514	91.352.614
Face print	Face diameter ▶ Mounting ▼	400 mm Item No.	500 mm Item No.	600 mm Item No.
DIN bar markings	wall	91.352.422	91.352.522	91.352.622
	ceiling	91.352.423	91.352.523	91.352.623
	tube	91.352.424	91.352.524	91.352.624
Options				Suffix
Packaging against dust and spray (protection grade IP 54)				-54
Case with lugs for suspension by ropes or chains				-30

Clocks for Clean Rooms

with stainless steel cases V4A for in-wall mounting

The clocks for clean rooms with V4A stainless steel cases described hereafter have been developed for the use in operating theatres in hospitals in particular – flush to the wall, hygienically safe, dependable and precise!

Also applicable in all other clean room environments such as in the pharmaceutical, beverage or food industries.

Digital clocks may be also used in stopwatch mode.

Stainless steel V4A

Due to its components stainless steel V4A is an alloy almost completely impervious not only to detergents and disinfectants, but also to acids and other aggressive media in particular. The flush-mounted clocks of this type series are therefore particularly suited for the use surgical operating rooms and other clean rooms.

Type series 460

Analog Clock for In-Wall Mounting, Round

dia 301 mm

ideal for surgical operating rooms and other clean rooms



91.460.310



91.460.321

Very high grade stainless steel case (1.4571 X6CrNi-MoTi 17-12-2, German trade name V4A), for in-wall-mounting, with diameter 301 mm. Visible surface with a matted finish (K240), particularly resistant to acids, detergents and disinfectants. In mounted condition protected against dust and moisture to IP 54 (EN 60 529). Flat mineral glass, 3 mm. Choice of face printed with Arabic numerals of DIN bar markings. Black hour and minute hands, red second hand.

Mounting options:

- Metal frame for conventional brick walls
- Spring-clip attachment for stud-and-panel walls

Please inquire about installation dimensions, if required!

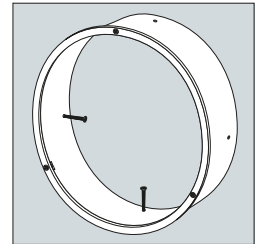

Metal mounting frame for in-wall mounting in conventional brick walls

Clock type		Item No.
NTP system clock (NTP client), synchronisation by LAN, PoE ³⁾		91.460.
Face print	Mounting	▲
Arabic numerals	with mounting frame	310
	for stud-and-panel walls	311
DIN bar markings	with mounting frame	320
	for stud-and-panel walls	321

Type series 470

Analog Clock for In-Wall Mounting, Square

301 x 301 mm

ideal for surgical operating rooms and other clean rooms



91.470.310



91.470.321

Very high grade stainless steel case (1.4571 X6CrNi-MoTi 17-12-2, German trade name V4A), for in-wall-mounting, dimensions 301 x 301 mm. Visible surface with a matted finish (K240), particularly resistant to acids, detergents and disinfectants. In mounted condition protected against dust and moisture to IP 54 (EN 60 529). Flat mineral glass, 3 mm. Choice of face printed with Arabic numerals of DIN bar markings. Black hour and minute hands, red second hand.

Mounting options:

- Metal frame for conventional brick walls
- Spring-clip attachment for stud-and-panel walls
- Stainless steel case V4A for on-wall mounting

Please inquire about installation dimensions, if required!

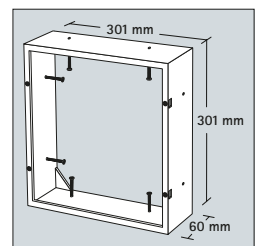

Metal mounting frame for in-wall mounting in conventional brick walls

Clock type		Item No.
NTP system clock (NTP client), synchronisation by LAN, PoE ³⁾		91.470.
Face print	Mounting	▲
Arabic numerals	with mounting frame	310
	for stud-and-panel walls	311
	for on-wall mounting	312
DIN bar markings	with mounting frame	320
	for stud-and-panel walls	321
	for on-wall mounting	322

Type series 480 **Analog Clock for In-Wall Mounting, Square**
with digital stopwatch display, ideal for surgical operating rooms

301x387 mm



91.480.310



91.480.321

Very high grade stainless steel case (1.4571 X6CrNiMoTi 17-12-2, German trade name V4A), for in-wall-mounting, dimensions 301 x 387 mm. Visible surface with a matted finish (K240), particularly resistant to acids, detergents and disinfectants. In mounted condition protected against dust and moisture to IP 54 (EN 60 529). Flat mineral glass, 3 mm. Choice of face printed with Arabic numerals or DIN bar markings. Black hour and minute hands, red second hand. Includes red 6-digit LED digital display, cipher height 25 mm, 230 VAC operating voltage, for stopwatch display, counting up. Operation by wire-bound remote control (accessory, see below).

Clock type	Item No.
NTP system clock (NTP client), synchronisation by LAN, PoE ²⁾	91.480.
Face print	Mounting
Arabic numerals	with mounting frame for stud-and-panel walls 310
	for on-wall mounting 311
	for stud-and-panel walls 312
DIN bar markings	with mounting frame for stud-and-panel walls 320
	for on-wall mounting 321
	for on-wall mounting 322

Mounting options:

- Metal frame for conventional brick walls
 - Spring-clip attachment for stud-and-panel walls
 - Stainless steel case V4A for on-wall mounting
- Please inquire about installation dimensions, if required!

Type series 490 **Analog Clock for In-Wall Mounting**
with digital stopwatch mode (optional), ideal for surgical operating rooms

455x150 mm



91.490.550



91.490.551

Very high grade stainless steel case (1.4571 X6CrNiMoTi 17-12-2, German trade name V4A), for in-wall-mounting, dimensions 455 x 150 mm. Visible surface with a matted finish (K240), particularly resistant to acids, detergents and disinfectants. In mounted condition protected against dust and moisture to IP 54 (EN 60 529). Flat mineral glass, 3 mm. Red 6-digit LED digital display, cipher height 57 mm, power supply via PoE (Power over Ethernet), 230 VAC operating voltage. Optionally, with stopwatch mode, counting up. Operation by wire-bound remote control (accessory, see below).

Clock type	Operating voltage	Item No.
NTP system clock (NTP client), synchronisation by LAN ¹⁾³⁾	PoE	91.490.
Mounting		
with mounting frame for stud-and-panel walls		550
for on-wall mounting		551
		552

Mounting options:

- Metal frame for conventional brick walls
- Spring-clip attachment for stud-and-panel walls
- Stainless steel case V4A for on-wall mounting

Type series 498 **Remote Control, Wire-Bound**
for surgical operating room clocks with LED digital displays

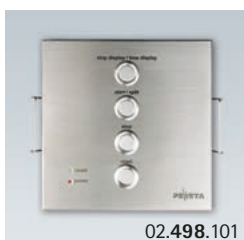

02.498.101



02.498.102

Stainless steel case (1.4571 X6CrNiMoTi 17-12-2, German trade name V4A), with a matted finish. 4 buttons for stopwatch mode/clock mode, start/stop, split times, and reset. Power supplied by the clock's LED display.

Available case types:

- With metal frame for conventional brick walls
- With spring-clip attachment for stud-and-panel walls
- Hand-held

Please inquire about installation/case dimensions, if required!

Type	Item No.
Remote control with mounting frame for in-wall mounting, stainless steel V4A	02.498.100
Remote control with mounting kit for stud-and-panel walls, stainless steel V4A	02.498.101
Hand-held remote control, stainless steel V4A	02.498.102

Type series 510 **LED Digital Clock** for indoors
with 4-digit display, single or double-face

CH 57+100 mm



Elegant digital clock with high-grade red bar-type LEDs for offices, production areas, and industrial use

Available with cipher heights 57 mm or 100 mm. Extra flat aluminium case, enamelled black. 4-digit display of hour and minute, automatic brightness control, flat acrylic glass. Choice of single face version for on-wall mounting or double face version including wall or ceiling mounting device.

Clock type	Cipher height ▶	
	57 mm Item No.	100 mm Item No.
Single face, on-wall mounting	91.510.551	91.510.951
Double face, including wall mounting bracket, length cir. 125 mm	91.510.552	n. available
Double face, including ceiling mounting tube, length cir. 130 mm	91.510.553	91.510.953

Technical data	Cipher height 57 mm	Cipher height 100 mm
	Reading dist.	cir. 20 m
Case dimensions (WxHxD)	cir. 320x150x34 mm (single face version)	cir. 520x250x43 mm (single face version)

Type series 511 **LED Digital Clock** for indoors
with 6-digit display, single or double-face

CH 57+100 mm



Elegant digital clock with high-grade red bar-type LEDs for offices, production areas, and industrial use

Available with cipher heights 57 mm or 100 mm. Extra flat aluminium case, enamelled black. 6-digit display of hour, minute, and second, automatic brightness control, flat acrylic glass. Choice of single face version for on-wall mounting or double face version including wall or ceiling mounting device. Seconds display also available with cipher height 38 mm as an option.

Clock type	Cipher height ▶	
	57 mm Item No.	100 mm Item No.
Single face, on-wall mounting	91.511.551	91.511.951
Double face, including wall mounting bracket, length cir. 125 mm	91.511.552	n. available
Double face, including ceiling mounting tube, length cir. 130 mm	91.511.553	91.511.953

Technical data	Cipher height 57 mm	Cipher height 100 mm
	Reading dist.	cir. 20 m
Case dimensions (WxHxD)	cir. 440x150x34 mm (single face version)	cir. 770x250x43 mm (single face version)

Type series 516 **LED Digital Calendar Clock** for indoors
time, day-of-week and date display, single or double-face

CH 57/30/45 mm



Elegant digital clock with high-grade red bar-type LEDs for places of high publicity

Extra flat, very sturdy metal case, enamelled black (RAL 9005). 3-line display of hour and minute, cipher height 57 mm (optional seconds, cipher height 38 or 57 mm), spelled-out day of the week (10-digit alphanumerical line, character height 30 mm), and date (8-digit numerical line, cipher height 45 mm). Automatic brightness control, flat acrylic glass. Choice of single face version for on-wall mounting or double face version including wall or ceiling mounting device.

Clock type	Item No.
Single face, on-wall mounting	91.516.551
Double face, including wall mounting bracket, length cir. 125 mm	91.516.552
Double face, including ceiling mounting tube, length cir. 130 mm	91.516.553

Technical data	
Reading distance	cir. 18..20 m
Case dimensions (WxHxD)	cir. 440 x 300 x 34 mm (single face version)

Type series 525

LED digital clock rim-circle seconds indication with optional add-on for displaying additional information

dia 400 mm



91.525.511 -77



91.525.551 -75 -77

Elegant digital clock with high-grade red bar-type LEDs for broadcasting facilities and places of high publicity

Metal case enamelled black, round, 400 mm diameter. 4-digit display of hour and minute, cipher height 57 mm. Circumferential ring of red LED bars indicating the seconds, counting up. Automatic brightness control, flat acrylic glass. Optionally including additional 8-digit alphanumeric display, character height 30 mm, to display different types of information:

- 8-digit date display (26.08.2024)
- day of the week, spelled out (Monday)
- day of the week, abbreviated and date (Mon 26.08.)
- day of month and abbreviated month (26. Aug 24)
- additional display for seconds (48)
- stopwatch function (hh/mm/ss, option)
- temperature (20°C, option)
- city names with corresponding world time and time-zone details (city pre-sets, option), as a single clock or as part of a World Time Clock system, see page 8.

Clock type	Item No.
Single face, on-wall mounting	91.525.551
Options	Suffix
Stopwatch mode »count-up/count-down« (remote control is an accessory)	-71
City pre-sets for World Time Clock Systems	-75
Additional 16-segment, 8-character alphanumeric display	-77
Alternating temperature display (external temperature sensor included)	-88

Type series 548

»Basic PRO« Remote Control Unit for LED PEWETA digital clocks equipped with stopwatch mode



91.548.251

Remote control unit for LED digital clocks

This active, wire-bound "Basic PRO" remote control unit is capable of turning PEWETA LED digital clocks into stopwatches (stopwatch mode is an option), and acts as a terminal for their operation. Connection is established via network/LAN. The remote control unit enables synchronous count-up/count-down functions of all connected LED digital clocks. Since each clock within the system can be addressed individually, either one remote control unit can control several stopwatches in various locations or several remote control units can trigger a single LED stopwatch equally, e.g. at different work stations. By means of software, these functions can be flexibly defined and can be easily selected by the user.

Functions

- **Count up**
Count up from "00:00:00"
- **Count down**
Enter a start value in hours, minutes, and seconds. Count down to "00:00:00"
- **Count down to (target time)**
Enter a target time. The time remaining will be automatically calculated and displayed. Count down to "00:00:00".

Type

This remote control unit features a network connection (RJ45). Time and date are imported via NTP. Power is supplied via PoE (Power over Ethernet). Remote control units and LED digital clocks may be individually assigned via a web browser.

Case

Sturdy plastic tip-up case for desktop use. Dimensions (length x width) cir. 175 x 105 mm.
5" LCD touchscreen, active area cir. 108 x 65 mm, for easy operation.

Type	Item No.
»Basic Pro« remote control unit, NTP/PoE	91.548.251

Type series 535

LED World Time Clock

CH 57+100 mm

as stand-alone units or combined into an integrated system



LED World Time Clocks for places of high publicity

These PEWETA World Time Displays can be used as standalone units as well as combined with further LED World Time Displays into an integrated system. Extra flat, sturdy metal case, enamelled black (RAL 9005). Choice of 2 or 3 4-digit time displays, cipher height 57 mm. Permanent text overlays below the time displayed indicate the names of the cities chosen. The software already contains the "pre-sets" pertaining to various time zones and city names, so that all units can easily be set up to always show the correct time. Time zones may be by changed by means of a web browser at any time.



Clock type	Cipher height	Item No.
World time display with 2 world times (hour/minute)	57 mm	42.535.521 -98
World time display with 3 world times (hour/minute)	57 mm	42.535.531 -98
Local time display, 4 digits (hour/minute)	100 mm	42.535.911 -98
Local time display, 6 digits (hour/minute/second)	100 mm	42.535.921 -98

On request, alphanumeric LED digital display for city names can be supplied (instead of permanent text overlays, suffix -72). The time zones as well as the names of the cities may be set and changed at any time by means of a web browser. Recommended for applications where regular adjustment is required.



Examples of World Time Clock Systems

Compile your PEWETA World Time Clock System according to your individual ideas and requirements. Depending on the number of time zones desired, all types of PEWETA LED display units may be combined freely.



World Time Clock with 5 time zones, consisting of 1 local time display (centred) and 2 World Time displays with 2 time zones each



World Time Clock with 7 time zones, consisting of 1 round LED clock showing local time (centred) and 2 World Time displays with 3 time zones each



World Time Clock with 7 time zones, consisting of 1 local time display (centred) and 2 World Time displays with 3 time zones each

Outdoor Clocks

single and double face

Type series 730 **Outdoor clock**

Type series 732 single face for wall mounting or double face with wall or ceiling bracket, not backlighted

dia 400 .. 600 mm



Sturdy outdoor clock for well lit areas.

Available with case diameters 446 mm, 546 mm, and 646 mm. Very sturdy, weatherproof metal case (IP 54), enamelled in metallic dark gun metal (DB703), choice of face printed with Arabic numerals or DIN bar markings. Black hour and minute hands. Choice of single face for wall mounting or double face with wall or ceiling mounting bracket, length cir.210 mm.

Option:

■ **Resistance to thrown balls acc. to DIN 18032/3**

Clocks of this type series are also available resistant to thrown balls and thus suitable for use in school yards. Very sturdy case with three-point mounting as a safeguard, proof against wrenching off the hook. Front glass is a 2-layer laminated safety glass, 6 mm thick. The clocks are certified and labelled "resistant to thrown balls according to DIN 18 032, part 3"

Face print Arabic numerals	face diameter ▶ mounting ▼	400 mm Item No.	500 mm Item No.	600 mm Item No.
Single face	wall	91.730.411	91.730.511	91.730.611
Double face	wall	91.732.412	91.732.512	91.732.612
Double face	ceiling	91.732.413	91.732.513	91.732.613

Face print DIN bar markings	face diameter ▶ mounting ▼	400 mm Item No.	500 mm Item No.	600 mm Item No.
Single face	wall	91.730.421	91.730.521	91.730.621
Double face	wall	91.732.422	91.732.522	91.732.622
Double face	ceiling	91.732.423	91.732.523	91.732.623

Option	Suffix
Resistance to thrown balls acc. to DIN 18032, part 3	-59

Type series 750 **Outdoor clock**

Type series 752 single face for wall mounting or double face with wall or ceiling bracket, backlighted by LED

dia 600 .. 800 mm



Weatherproof outdoor clock with LED backlighting for optimum reading conditions.

Available with case diameters 670 mm and 902 mm. Very sturdy, weatherproof metal case (IP 54), enamelled light grey (RAL 7035), choice of face printed with Arabic numerals or DIN bar markings. Black hour and minute hands. Choice of single face for wall mounting or double face with wall or ceiling mounting bracket, length cir. 240 mm. Backlighting by durable, maintenance-free light-emitting diodes (LEDs), operating voltage 230 VAC/50...60 Hz.

Face print Arabic numerals	face diameter ▶ mounting ▼	600 mm Item No.	800 mm Item No.
Single face	wall	91.750.611	91.750.811
Double face	wall	91.752.612	91.752.812
Double face	ceiling	91.752.613	91.752.813

Face print DIN bar markings	face diameter ▶ mounting ▼	600 mm Item No.	800 mm Item No.
Single face	wall	91.750.621	91.750.821
Double face	wall	91.752.622	91.752.822
Double face	ceiling	91.752.623	91.752.823

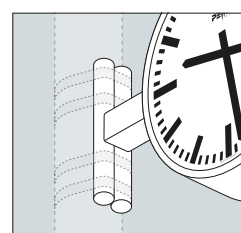

Pole adapter for lateral mounting by means of stainless steel tightening straps (option, suffix -35)

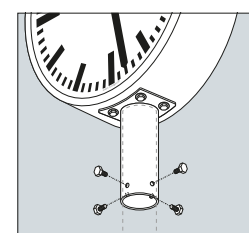

Pole adapter for central mounting (option, suffix -36)

■ **Synchronising time in a network by NTP**

Network Time Protocol (NTP) is a server/client protocol used to provide time and date synchronisation in IT networks. Local networks (LAN) in industry or public administration may use it as well as wide-ranging networks, e.g. the Internet. NTP is universally compatible. Originally developed for the UNIX Operating System, today it is synchronising all relevant Operating Systems, like Windows, Mac OS, Linux ...

PEWETA NTP system clocks (SNTP clients) may receive the NTP protocol and will adjust themselves, accurate to the second. If the network includes a DHCP server (protocol for automatic client configuration by a server) configured accordingly, setup will be carried out in a "plug-and-play" fashion. A web-based user interface makes changes in the setup a comfortable task to be carried out in an internet browser. PEWETA NTP system clocks receive their power supply by PoE (Power over Ethernet), thus a single cable is sufficient for connection. Since every PEWETA NTP system clock may be adjusted to the local time zone or any other time zone desired by the user, these clocks may be used world-wide or may be assembled into a World Time Display. PEWETA NTP system clocks are easy to install and operate, and generally maintenance-free as well as energy efficient.

